



**FOUR
POINTS**
BY SHERATON

**Four Points by Sheraton Sydney,
Darling Harbour**

New Conference Space & Tower Opening mid-2016

161 Sussex Street, Sydney, NSW 2000 Australia
Fourpoints.com/sydney

T +61 2 9290 4000 **F** +61 2 9290 4040
E sydneyevents@fourpoints.com

OUR JOURNEY CONTINUES

**Everything you need to meet the way
you like. That's Four Points by Sheraton
Sydney, Darling Harbour**

Inspire the best from your team with our upcoming event space. With excellent service, we ensure a productive meeting whether big or small – our 3,700 square metres of flexible meeting and event space can easily accommodate up to 2,100 people.

Our space includes the 850-square-metre Grand Ballroom and the 895-square-metre Maritime Ballroom both with Darling Harbour views and natural light. We will have 21 new function spaces, all equipped with Wi-fi access, state of the art audiovisual and a wide range of catering services.

Then when the day is done, your guests can relax in one of our 892 refurbished guestrooms, or have a little indulgence in the brand new 300 seat restaurant or contemporary bar where you will forget you're in Australia's largest hotel.

And you'll find our hotel in one of the best spots in town overlooking Darling Harbour. We're a short stroll from the heart of the city, and surrounded by Sydney's best entertainment and shopping precincts including Pitt Street Mall and Queen Victoria Building.

A world class venue to meet all of your requirements.



FOURPOINTS.COM/SYDNEY

Stylish Rooms

Start with the modern amenities you expect and the style you deserve in one of our 892 guestrooms. Enjoy a hot cup of coffee or tea, relax in front of our LCD TV's, stay connected to your world through our Wi-fi, all before you get a great night sleep in our comfortable Four Points beds.

The Space You Need

Our hotel will feature 21 unique meeting and event spaces, fully flexible to meet the needs and requirements of your next function, no matter what size it is. The Maritime and Grand Ballrooms will have a combined capacity of 2,100 guests.

Easy Event Planning

When you book with Four Points by Sheraton Sydney, Darling Harbour - you can create a custom, easy-to-use website for your event with StarGroups, one of our online meeting resources.

Always a Great Stay

Get everything you're looking for with the style and service you want, all at a great price. We have what matters most to you, like a 24-hour fitness centre, a variety of venues where your guests can relax and grab a Best Brew plus our award winning Concierge team that are on call to assist with any request.

Delicious Meals

Start your day with a delicious breakfast at our 300 seat all-day dining restaurant or grab a lite snack and morning coffee from our contemporary Lobby Bar. During the evening your guests can enjoy the atmosphere with a cold beer and cheer on your favourite team at the heritage listed Dundee Arms Pub. If you're after something a little more intimate, then head to our rooftop bar (opening Q4 2016), order a cocktail, relax on a sun-lounge and watch the sunset over Darling Harbour. The choice is yours.

Loyalty Counts

Guests can earn points as part of Starwood Preferred Guest, the world's leading loyalty program. SPG members earn Starpoints with every eligible stay and also receive 15% off food in our restaurant.

These points can be redeemed on free nights at more than 1,100 Starwood Hotels and Resorts in nearly 100 countries around the world; and guess what - there are no blackout dates.

Reduce Impact & Increase Responsibility

Hold your meeting with us and take advantage of our Global Citizenship initiative. Highlight the sustainable options that are important to you from our comprehensive menu and make a conscious choice about reducing your environmental impact. Let us help you meet your own sustainability.

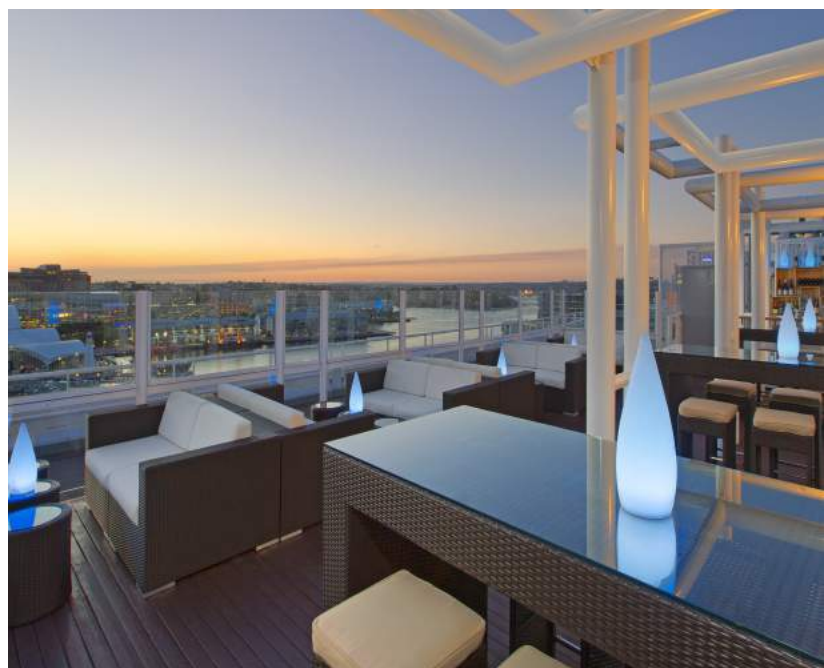

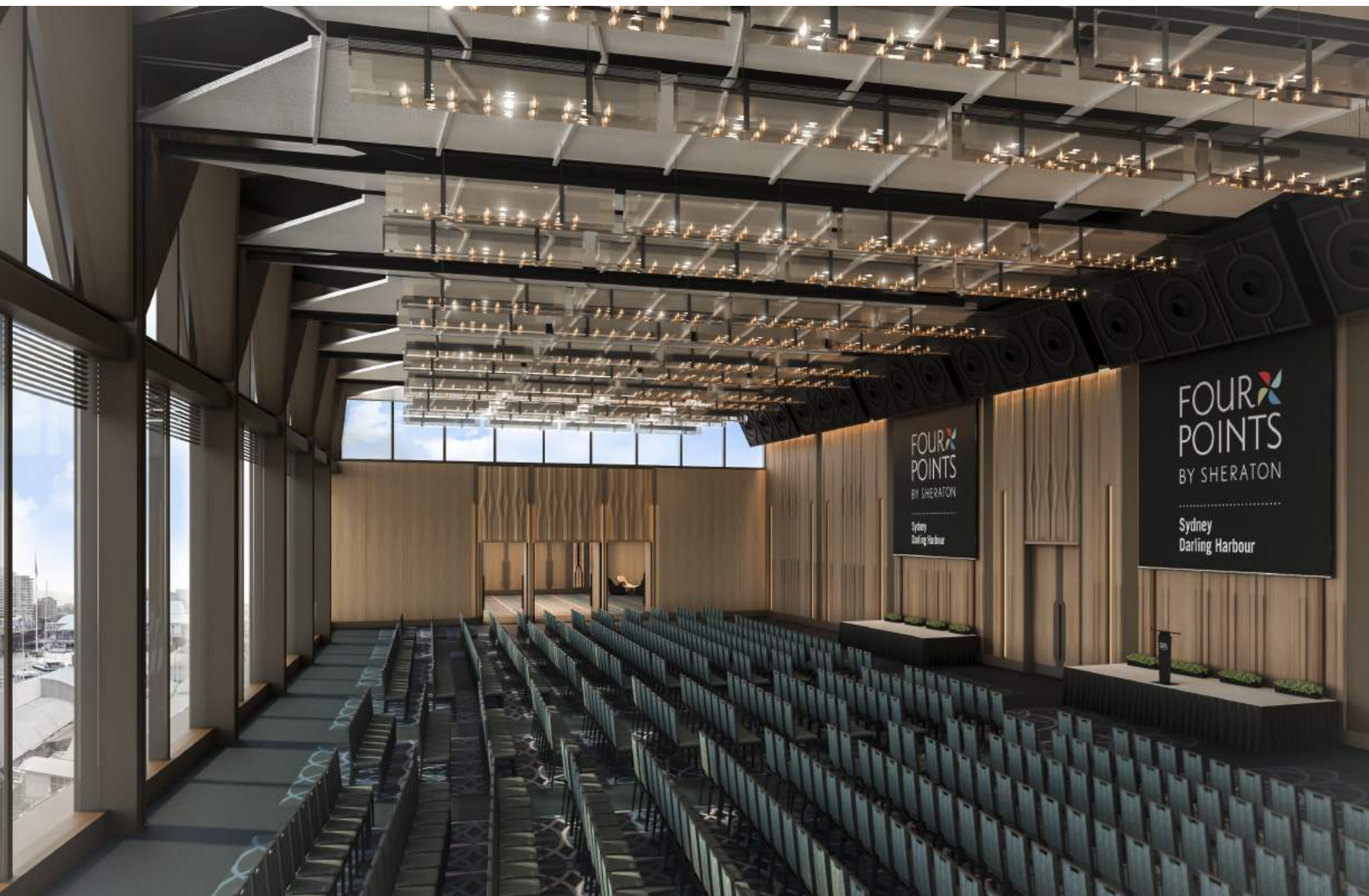



Here We Are

FROM EAST

Proceed along New South Head Road. Continue along William Street and then onto Park Street. As it becomes Druiitt Street turn right onto Kent Street. Travel approximately three blocks and turn left onto Erskine Street. At the next set of lights, turn left onto Sussex Street and continue past the Bristol Arms Pub and the hotel will be on your right.

FROM NORTH

Take the Pacific Highway/ Warringah Highway and proceed over the Sydney Harbour Bridge. Take the York Street exit off the bridge and continue along before turning right onto Erskine Street. Proceed approximately three blocks before turning left onto Sussex Street and continue past the Bristol Arms Pub and the hotel will be on your right.

FROM WEST

Take the Western Distributor towards the Sydney CBD, taking the City North exit, followed by the Sussex Street South exit. Turn right onto Sussex Street and continue past the Bristol Arms Pub and the hotel will be on your right.

FROM SOUTH

Travel along Southern Cross Drive and take the South Dowling Street exit. Continue along South Dowling Street and then turn left onto Flinders Street and continue until you reach Oxford Street. Turn left onto Oxford Street and continue until it joins Liverpool Street and continue along Liverpool Street. Turn right onto Kent Street and continue approximately seven blocks and turn left when you reach Erskine Street. At the next set of lights, turn left onto Sussex Street and continue past the Bristol Arms Pub and the hotel will be on your right.

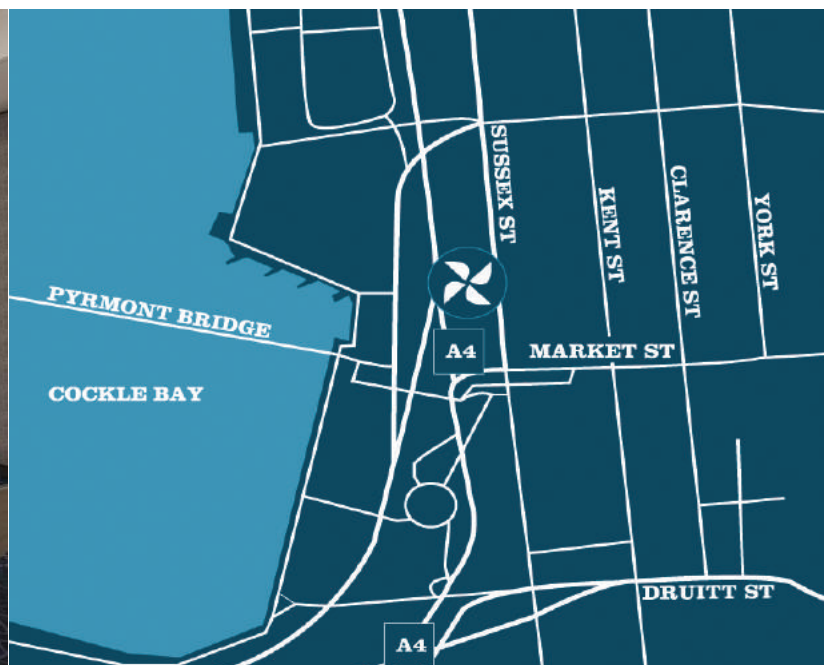

Ground Level

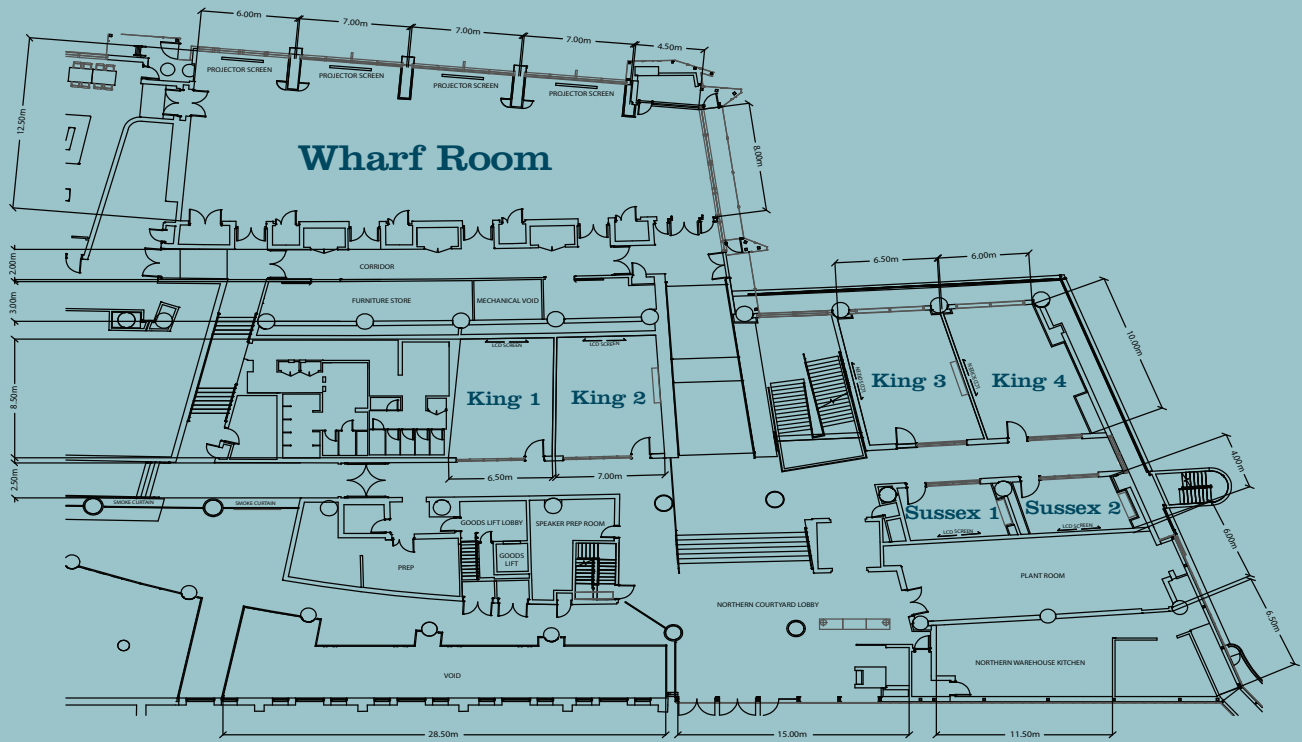

Mezzanine Level

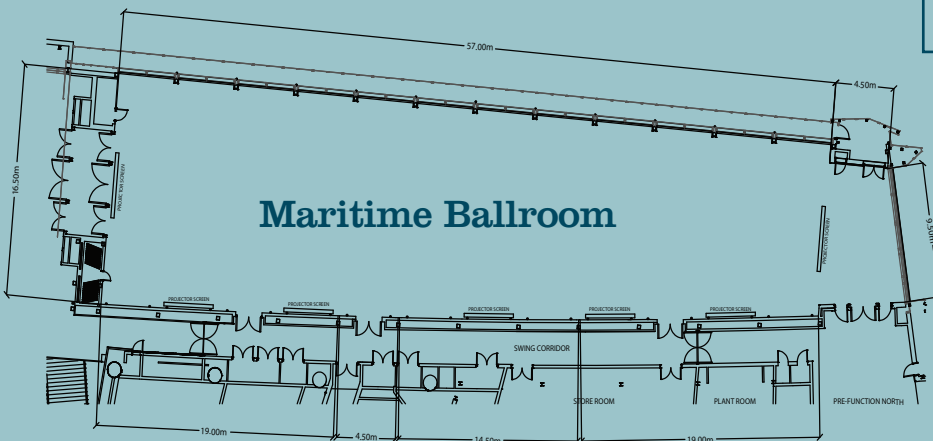
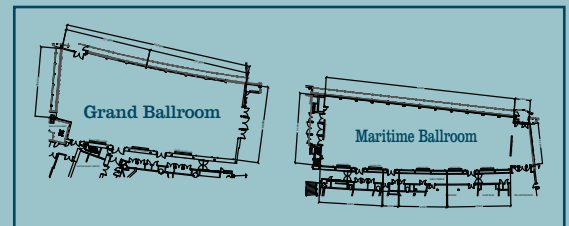
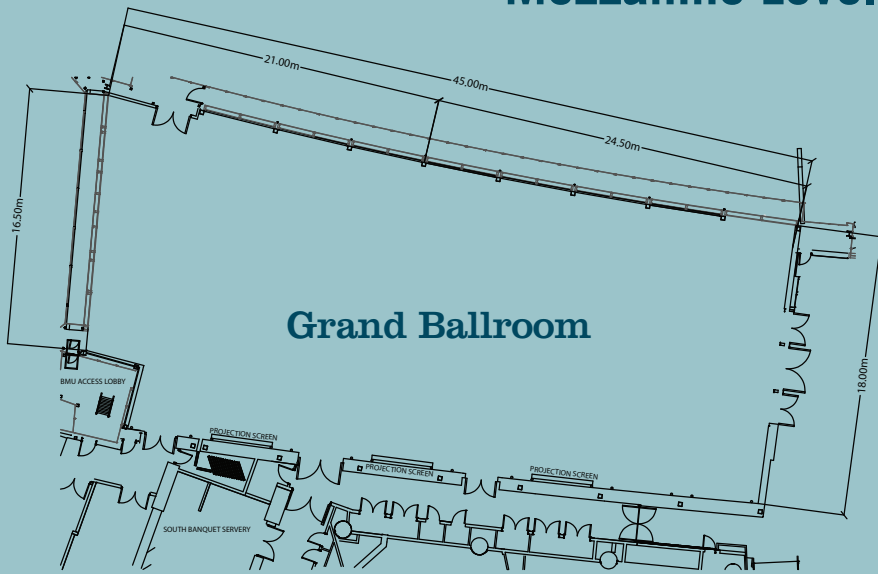

Meeting Capacity Chart - Coming June 2016

SPACE	SQUARE METRES	SQUARE FEET	CEILING HEIGHT	THEATRE	CLASSROOM	U-SHAPE	ROUNDS OF TEN	COCKTAIL	CABARET	BOARDROOM	BOOTH 3X3	BOOTH 3X2
Grand Ballroom	850	9149	8.5	1100	660	-	800	1100	600	-	41	50
Grand 1	382	4112	8.5	500	280	-	350	500	280	-	16	21
Grand 2	466	5016	8.5	600	350	-	400	600	320	-	25	28
Maritime Ballroom	895	9634	6.5	1000	670	-	800	1000	600	-	43	68
Maritime 1	303	3261	6.5	350	230	-	280	350	220	-	14	22
Maritime 2	72	775	6.5	70	36	-	60	70	50	-	-	-
Maritime 3	209	2250	6.5	230	160	-	200	230	150	-	11	20
Maritime 4	305	3283	6.5	350	230	-	280	350	220	-	13	22
Wharf Room	342	3681	3.0	355	225	-	280	355	208	-	-	-
Wharf Room 1	74	796	3.0	80	30	25	50	80	40	28	-	-
Wharf Room 2	80	861	3.0	90	36	25	60	90	48	26	-	-
Wharf Room 3	75	807	3.0	80	36	25	60	80	48	26	-	-
Wharf Room 4	70	753	3.0	70	36	22	60	70	48	24	-	-
Wharf Room 5	43	463	3.0	35	10	18	20	35	16	20	-	-
King Room 1	54	581	3.0	60	24	18	40	60	32	22	-	-
King Room 2	57	613	3.0	60	24	18	40	60	32	22	-	-
King Room 3	65	700	3.0	60	33	22	40	60	32	24	-	-
King Room 4	62	667	3.0	60	33	22	40	60	32	24	-	-
Sussex Room 1	24	258	3.0	20	12	12	10	20	8	12	-	-
Sussex Room 2	25	269	3.0	20	12	12	10	20	8	12	-	-

©2013–2016 Starwood Hotels & Resorts Worldwide, Inc. All Rights Reserved. Preferred Guest, SPG, Aloft, Design Hotels, Element, Four Points, Le Méridien, Sheraton, St. Regis, The Luxury Collection, Tribute, W, Westin and their logos are the trademarks of Starwood Hotels & Resorts Worldwide, Inc., or its affiliates.

spg*
Starwood
Preferred
Guest

